

## Notice about the result of Admission/Tuition Fee Exemption for the First Half of AY2025

The purpose of this program is to help students who excel academically but suffer economic hardships so that they do not give up continuing their academic studies. We appreciate your full understanding of our efforts to operate the exemption program under a very tight budget.

### How to check the Admission Fee Exemption result

Please log in to UTAS and check the “Bulletin Board” > “Newly Arrived” > “Administrative messages” section.

### How to check the Tuition Fee Exemption result

Please log in to UTAS and check the “Student Info” > “View University Registry Information” > “Tuition Fee Exemption/Payment Status Information” section.

### Payment Instructions for Tuition Fees

Please note that the scheduled Direct Debit Payment Date is **Wednesday, August 27**. Students who have been approved for reduced payment, or whose application for tuition fee exemption has not been approved, and who have arranged for direct debit payments, should ensure that the equivalent amount of their tuition fees is deposited into their account by 15:00 on Tuesday, August 26. Students who have not registered for direct debit should pay their tuition fees according to the invoice that will be sent by the Accounting Group around late August. If you have not yet arrived in Japan, please contact the academic affairs office of your affiliated faculty or graduate school for instructions on how to pay your tuition fees.

### Tuition Fee Exemption for the Second Half of AY2025

If you have already applied for both the first and second half together, you do not need to apply again for the second half. However, if there are any changes in the situation of your family finances or your family members from the previous application, or if you change your course of study from the second half (e.g., from a master's to a doctoral course), you will need to reapply for the second half. Furthermore, please note that the results of the application will not be automatically carried over to the second half. The exemption from tuition fees for the second half will be determined through another screening process. With regards to the exemption from tuition fees for the second half, please check the details on our website or bulletin boards.

#### ■Inquiries

For any questions regarding the result of your admission or tuition fee exemption, please use the following form as the primary contact method.

\*UTokyo Account login is required.

Inquiry Form for Questions Regarding Admission/Tuition Fee Exemption

<https://forms.office.com/r/6ws3GmQBzB>

# The Method of Checking Selection Result of Tuition Fee Exemption at UTAS

Tuition Fee Exemption: please check the page at UTAS as bellow.

URL: <https://utas.adm.u-tokyo.ac.jp/campusweb/>

## After logging in...

Please check the result of tuition fee exemption on **“PC page”**. If you log in to UTAS using a smartphone, please switch to the 'PC page' to view the website.

### 【スマホ版のトップ画面】

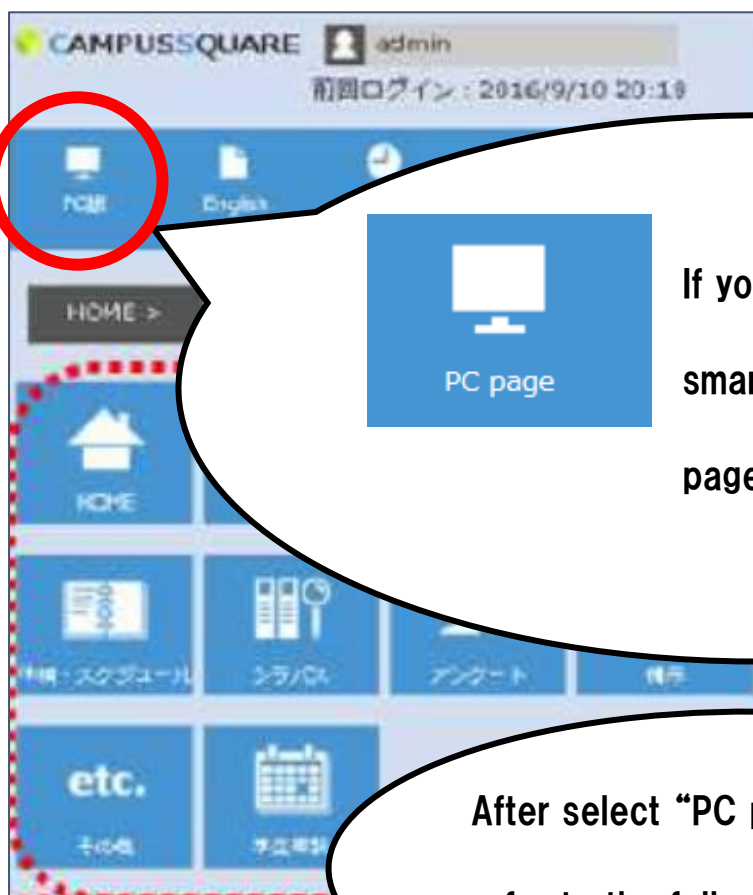

After select “PC page”, please refer to the following page.



## After logging in... (PC ver.)

UTokyo Academic Affairs System

HOME Student Info Schedule

Notice View University Registrar

View University Registry Information/Tuition Fee Exemption/ Payment Status Information

Student Basic Information

Student ID No. Name (Kata)

☐ Contact Information  
☒ Tuition Fee Exemption/ Payment Status Information

Please click on "Tuition Fee Exemption/Payment Status Information".

Tuition Exemption			
Academic year	Semester/Term	Exemption category	Financial sum of exemption
2024Academic year	First Half	Pending	0
2023Academic year	Second Half	Half exemption	130200
2023Academic year	First Half	Half exemption	130200
2022Academic year	Second Half	Half exemption	130200
2022Academic year	First Half	Half exemption	130200
2021Academic year	Second Half	Half exemption	130200

Tuition fee payment			
Academic year	Semester/Term	Payment status	Amount of payment
2024Academic year	First(April-September)	Unpaid	0
2023Academic year	Second(October-March)	Paid	130200
2023Academic year	First(April-September)	Paid	130200
2022Academic year	Second(October-March)	Paid	130200
2022Academic year	First(April-September)	Paid	130200
2021Academic year	Second(October-March)	Paid	130200